



0910 ASL 501



AS-Interface Module with 4-Digital Inputs

4 IN

AS-interface module with 4 digital inputs to connect M8 standards sensors, M8 bus connection.

- Version 2.1 -

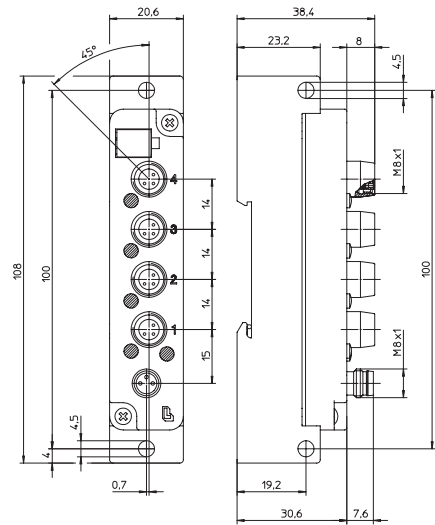

Bit Assignment

Bit	-	-	-	-	3	2	1	0
M12 Input								
Byte 0	-	-	-	-	I-4	I-3	I-2	I-1

Diagnostic Indication

LED	Indication	Condition
1..4	yellow	channel status
	green	slave is involved in data transfer
	red	communications error, no data transfer (e.g., slave address 0)
AS-I-DIA	red flashing	periphery error (e.g., sensor supply overload or short circuit)

Pin Assignment

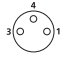
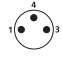
Bus Connection M8	Input M8
 <p>1 = AS-interface + 2 = AS-interface - 4 = n.c.</p>	 <p>1 = +24 V 2 = GND (0 V) 4 = IN</p>



Be Certain with Belden

AS-Interface Module with 4-Digital Inputs

0910 ASL 501

Technical Data

Environmental

Degree of protection	IP 67
Operating temperature range	-15°C (+5°F) to +60°C (+140°F)
Weight	100 g
Housing material	PUR

Bus system

AS-Interface profile	S 0.A.E
I/O configuration	0 hex
ID code	A hex
ID2 code (extended ID-code)	E hex
Support A/B addressing	yes

AS-Interface Version 2.1

Electronics power supply

Rated voltage	AS-Interface net
Voltage range	26.5–31.6 V DC
Power consumption	max. 120 mA
Reverse polarity protection	yes
Indication	LED green

AS-Interface

Inputs

Rated input voltage	24 V DC
Signal state "1"	Us > 11 V / Is > 6 mA
Signal state "0"	Is < 2 mA
Input current at	24 V 15 mA
Input circuit	p-switching
Number of digital channels	4
Channel status indicator	LED yellow per channel

Type 2 acc. to IEC 61131-2

Diagnostic

Indication	LED red
------------	---------

Connection via cordset, double-ended

M8 / M8	e.g. RSMV-RKMV (please see product group cordsets, double-ended)
---------	--

Included in delivery / Accessories

Dust covers M8	2 pieces
Attachable label	1 piece

Part Number

0910 ASL 501



The application of these products in harsh environments should always be checked before use.
Specifications subject to alteration.